

NOZZLES

High Quality Jetting for Waterblast Applications

ATTACK TIPS

StoneAge Attack Tips are the highest quality, longest lasting nozzles available for low and medium pressure applications (up to 22k psi/1500 bar). Flow straighteners correct turbulence, ensuring excellent jetting results.

Stainless or carbide steel available.

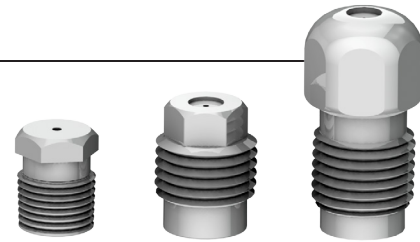

AP2
1/8 NPT

APF4
1/4 NPT
Flush mount

AP4
1/4 NPT

NOZZLE FLOW CHART

Nozzle Size		PRESSURE (PSI & BAR)																#								
		2,000 140		4,000 280		6,000 410		8,000 550		10,000 700		12,000 830		14,000 970		15,000 1000			16,000 1100		18,000 1200		20,000 1400		22,000 1500	
in.	mm																									
.018	0.46	0.4	2	0.6	2	0.7	3	0.8	3	0.9	3	1.0	4	1.0	4	1.1	4	1.1	4	1.2	5	1.2	5	1.3	5	0.6
.020	0.51	0.5	2	0.7	3	0.8	3	1.0	4	1.1	4	1.2	5	1.3	5	1.3	5	1.5	6	1.5	6	1.5	6	1.6	6	0.7
.022	0.56	0.6	2	0.8	3	1.0	4	1.2	5	1.3	5	1.4	5	1.5	6	1.6	6	1.6	6	1.7	6	1.8	7	1.9	7	0.8
.024	0.61	0.7	3	1.0	4	1.2	5	1.4	5	1.6	6	1.7	6	1.8	7	1.9	7	2.0	8	2.1	8	2.2	8	2.3	9	1.0
.026	0.66	0.8	3	1.2	5	1.4	5	1.6	6	1.8	7	2.0	8	2.1	8	2.2	8	2.3	9	2.4	9	2.6	10	2.7	10	1.1
.029	0.74	1.0	4	1.4	5	1.7	6	2.0	8	2.3	9	2.5	10	2.7	10	2.8	11	2.9	11	3.0	11	3.2	12	3.4	13	1.4
.032	0.81	1.2	5	1.7	6	2.1	8	2.5	10	2.8	11	3.0	11	3.3	13	3.4	13	3.5	13	3.7	14	3.9	15	4.1	16	1.7
.035	0.89	1.5	6	2.1	8	2.6	10	3.0	11	3.3	13	3.6	14	3.9	15	4.0	15	4.2	16	4.4	17	4.7	18	4.9	19	2.1
.038	0.97	1.7	6	2.5	10	3.0	11	3.5	13	3.9	15	4.3	16	4.6	18	4.8	18	4.9	19	5.2	20	5.5	21	5.7	22	2.5
.042	1.07	2.1	8	3.0	11	3.7	14	4.2	16	4.7	18	5.2	20	5.6	21	5.8	22	6.0	23	6.4	24	6.7	26	7.0	27	3.0
.047	1.19	2.7	10	3.8	14	4.6	18	5.3	20	5.9	22	6.5	25	7.0	27	7.3	28	7.5	29	8.0	30	8.4	32	8.8	34	3.8
.052	1.32	3.3	13	4.6	18	5.6	21	6.5	25	7.3	28	8.0	30	8.6	33	8.9	34	9.2	35	9.8	37	10	38	11	42	4.6
.057	1.45	3.9	15	5.5	21	6.8	26	7.8	30	8.7	33	9.6	37	10	38	11	42	11	42	12	46	12	46	13	50	5.5
.063	1.60	4.8	18	6.8	26	8.3	32	9.6	37	11	42	12	46	13	50	13	50	14	53	14	53	15	57	16	61	6.8
.069	1.78	5.7	22	8.1	31	9.9	38	12	46	13	50	14	53	15	57	16	61	16	61	17	65	18	69	19	72	8.1
.075	1.91	6.8	26	9.6	37	12	46	13	50	15	57	17	65	18	69	19	72	19	72	20	76	21	80	23	88	9.6
.082	2.08	7.2	27	10	38	13	50	14	53	16	61	18	69	19	72	20	76	20	76	22	83	23	88	24	91	10
.090	2.29	8.7	33	12	46	15	57	17	65	19	72	21	80	23	88	24	91	25	95	26	98	27	102	29	110	12
.098	2.49	10	38	15	57	18	69	21	80	23	88	25	95	27	102	28	106	29	110	31	117	33	125	34	129	15
.106	2.69	12	46	17	65	21	80	24	91	27	102	29	110	32	121	33	125	34	129	36	136	38	144	40	151	17
.115	2.92	14	53	20	76	25	95	28	106	32	121	35	132	37	140	39	148	40	151	42	159	45	170	47	178	20
.125	3.18	17	65	24	91	29	110	33	125	37	140	41	155	44	167	46	174	47	178	50	189	53	201	55	208	24
.135	3.43	20	76	28	106	34	129	39	148	44	167	48	182	52	197	53	201	55	208	58	220	62	235	65	246	28
.145	3.68	23	88	32	121	39	148	45	170	50	189	55	208	60	227	62	235	64	242	68	257	71	269	75	284	32
.155	3.94	26	98	36	136	45	170	51	193	57	216	63	238	68	257	70	265	73	276	77	291	81	307	85	322	36
.165	4.19	29	110	41	155	50	189	58	220	65	246	71	269	77	291	80	303	82	310	87	329	92	348	97	367	41